

# Gantan Seppan G-160

PAT.P

CONTACT :  
 GANTAN BEAUTY INDUSTRY CO., LTD.  
 International Business Department  
 E-mail : overseas@gantan.co.jp  
 Phone : +81-466-43-2187 / Fax : +81-466-45-3037  
 URL : <http://www.gantan.co.jp/english/index.html>



## Construction process

### Tight frame construction



### Fitting into the tight frame

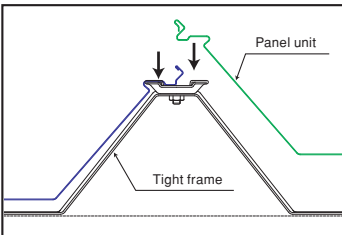

### Seam clamping



Distribution center

## Profile

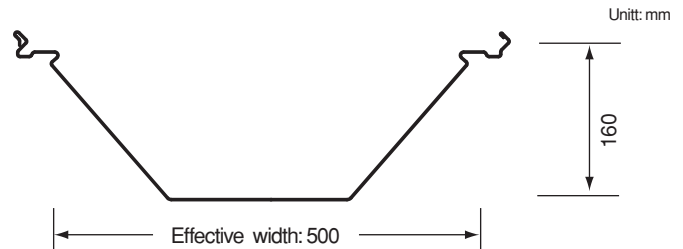

## Details (Gantan yuko system)

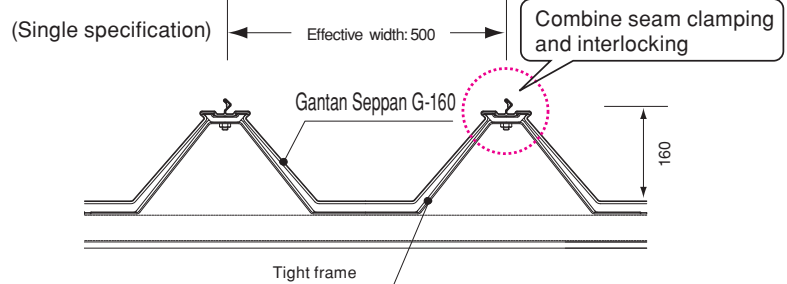

## Standard Materials Thickness

Material	Thickness
Painted galvalume steel	0.8, 1.0mm

## Specifications

- Effective width: 500mm
- Effective length: 11m or longer made on site
- For slopes of 3/100 or steeper

\* Ask us about radius of curvature, regions of low temperatures or snow accumulation, etc.

## (Double-back specification)

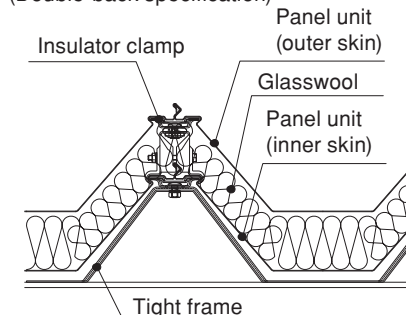

## Sectional performance

Sheet thickness (mm)	Positive pressure		Negative pressure	
	Second moment of the section Ix (cm <sup>4</sup> /m)	Section modulus Zx (cm <sup>3</sup> /m)	Second moment of the section Ix (cm <sup>4</sup> /m)	Section modulus Zx (cm <sup>3</sup> /m)
0.8	355.1	43.4	257.4	25.7
1.0	443.9	54.2	321.7	32.1